

Cromwells



Hazel Court , Diamond Jubilee Way, Carshalton, Surrey, SM5 4AS
Guide Price £350,000

A beautifully presented and modern two double bedroom first floor apartment, including a 23ft open plan kitchen/diner and two bathrooms. The property forms part of the popular sovereign park development which is within short walk of Carshalton Beeches train station as well as well performing schools and shopping facilities..



***Two double bedrooms *Long lease, Secure bike shed & own parking bay
*Private balcony *Excellent condition**

Entrance Hall

Storage cupboards

**Reception Room/Kitchen - 23' 3" x 12' 2"
(7.08m x 3.71m)**

Super large open plan reception room/kitchen, modern fitted kitchen, door leading to the balcony

Bedroom 1 - 14' 1" x 9' 9" (4.29m x 2.97m)

Two double glazed windows, Carpeted throughout, built-in wardrobe, en-suite shower room



Bedroom 2 - 13' 7" x 8' 4" (4.14m x 2.54m)

Two double glazed windows, carpeted throughout

Bathroom - 6' 11" x 5' 7" (2.11m x 1.70m)

Modern bathroom, three piece suite

Balcony



FIRST FLOOR
736 sq.ft. (68.4 sq.m.) approx.

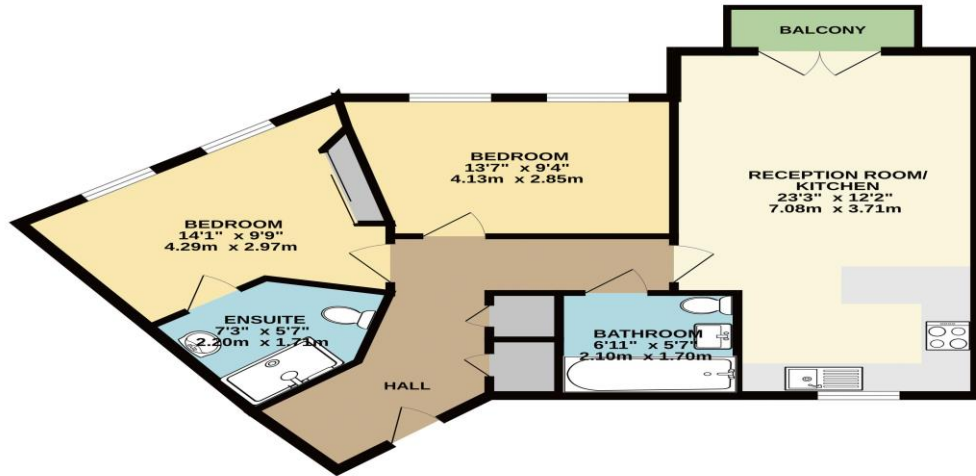

TOTAL FLOOR AREA: 736 sq.ft. (68.4 sq.m.) approx.
Whilst every attempt has been made to ensure the accuracy of the floorplan contained here, measurements of doors, windows, rooms and any other items are approximate and no responsibility is taken for any error, omission or mis-statement. This plan is for illustrative purposes only and should be used as such by any prospective purchaser. The accuracy, correctness and appearance shown hereon and hereon is not guaranteed.

Council Tax - D Local Authority: London Borough of Sutton Tenure - Leasehold



95 Banstead Road
Carshalton
Surrey
SM5 3NP



020 8642 5468



admin@cromwellscarshalton.com



www.cromwellsestateagents.uk

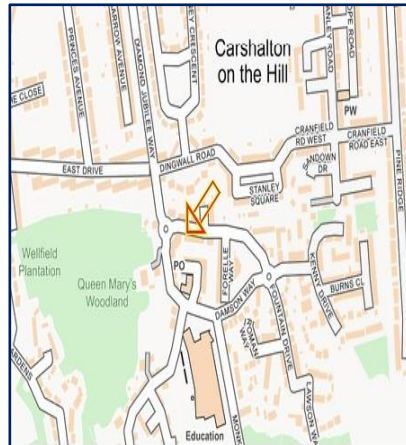

Disclaimer

These particulars are not an offer or contract, nor part of one. You should not rely on statements made by Cromwells in the particulars or by word of mouth or in writing ("information") as being factually accurate about the property, its condition or value. Neither Cromwells nor any joint agent has authority to make representations about the property, and accordingly any information given is entirely without responsibility on the part of the agents, seller(s) or lessor(s). Photographs show only certain parts of the property as they appeared at the time they were taken. Areas, measurements and distances are given as an approximate only. Any reference to alterations to or use of, any part of the property does not mean that any necessary planning, building regulations or other consents have been obtained